

**PAT10926**

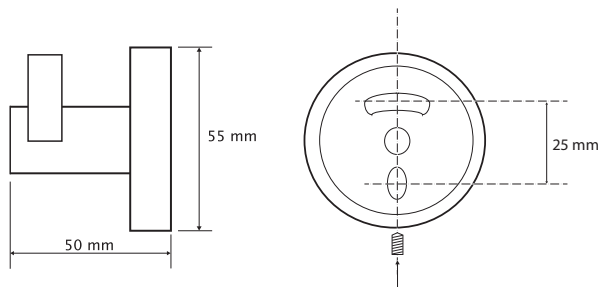

**FR** Spécifications techniques

**Patère double**

Caractéristiques

Matière : laiton

Finition : noir

Dimensions : L55 x H55 x P50mm

Fixation

Platine et vis pointeau

Visserie et chevilles fournies



**UK** Technical specifications

**Double hook**

Features

Material: brass

Finish : black

Dimensions : W55 x H55 x D50mm

Fixings

Support plate and grub screws

Screws and wallplugs included

